

EXHIBIT  
tabbles  
1



# Farmers Electric Cooperative

A Touchstone Energy Cooperative

301 N. Hillcrest  
Sulphur Springs, TX 75482

2000 I-30 E  
Greenville, TX 75402

108 W. Marble  
Wylie, TX 75098

Tuesday, June 26, 2018

Office of Hopkins County Judge  
PO Box 288  
Sulphur Springs TX 75483

**Farmers Electric Cooperative Member: LAURENCE HIRSCH**  
**Service Order Number: 1806005166**

Greetings:

Farmers Electric Cooperative, Inc. is requesting permission to construct electrical power distribution facilities across County Road 1173 which is located, 773 ft from CR 1209 in Hopkins County , Texas.

Site location map and construction sketches are enclosed. The construction sketch details the proposed work. All road crossings will have a minimum vertical clearance of 22 feet.

If you have any questions, please contact me at any time.

Sincerely,

*Matthew Walker*  
Project Coordinator

mwalker@farmersselectric.coop  
Phone 903-441-1368

Submitted by Brandon Darrow  
Field Engineering Coordinator

Enclosures

County Approval Section:

Approved:

Denied:

Authorized Signature: \_\_\_\_\_

Date: 7-3-18

HOPKINS COUNTY PERMIT REQ'D

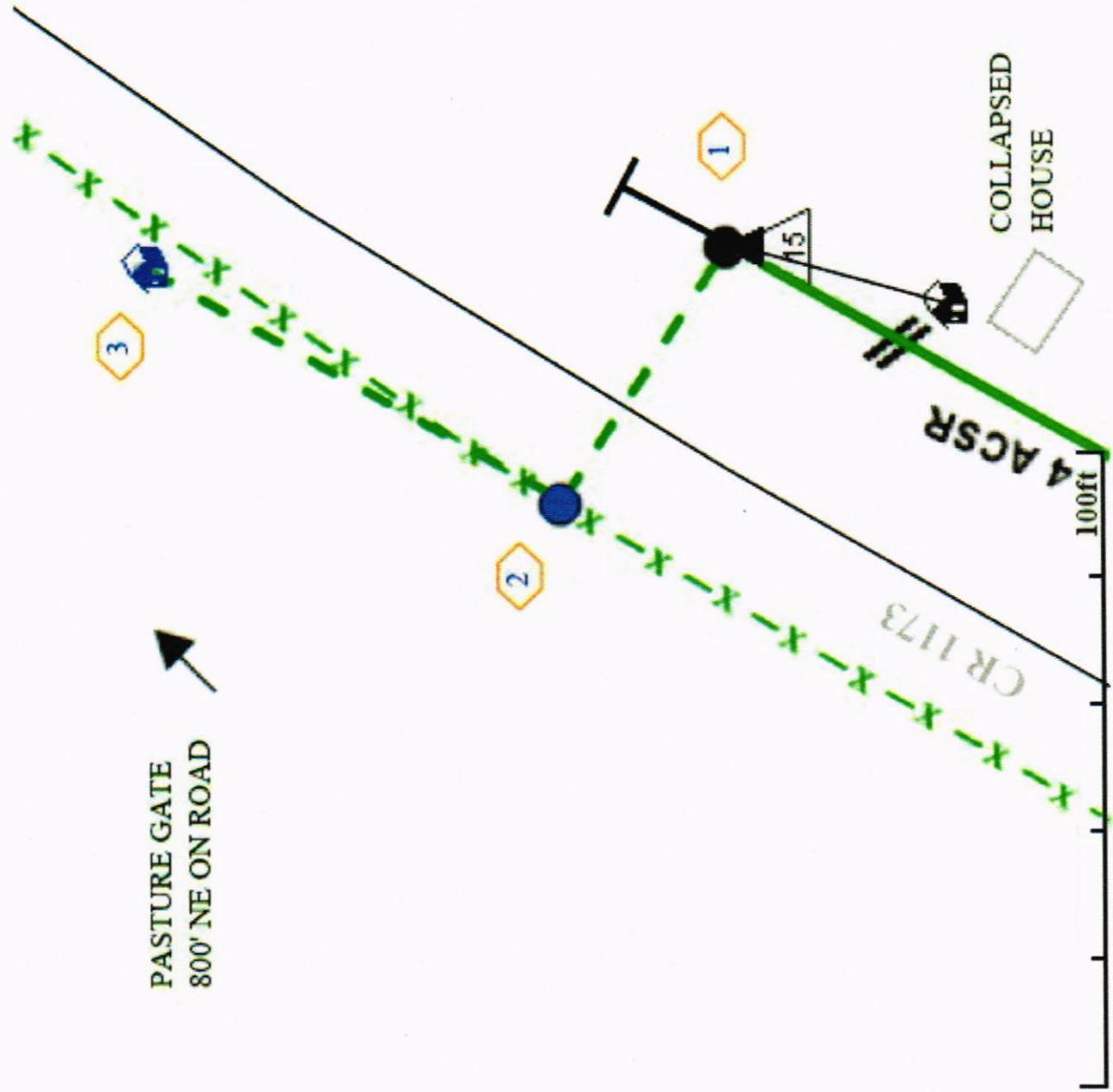

PASTURE GATE  
800' NE ON ROAD



P1 30' TO CR 1173  
& 773' TO CR 1209







Laurence Hirsch,  
service order#  
1806005166  
Cross CR 1173 at  
Pole#0800033

